



50 W Cannalily Lane
Clayton, NC 27520

**THE ESTATES AT WINSTON POINTE -
BEAUFORT**

CONTACT OUR NEW HOME SPECIALISTS

MAGGIE & JESSICA

Call Us @ 910-405-8311

info@cavinessandcates.com



Priced

\$617,000

Elevation C

3,224 Sq Ft

2.0 Story

5 Beds

4.5 Baths

2 Car Garage

Primary Bedroom: Down

About 50 W Cannalily Lane

- This home features a primary suite and guest suite on the first floor!
- Great room with gas log fireplace with decorative mantle and granite surround in "Absolute Black".
- Screened deck creates the perfect outdoor living space.
- Eat-in kitchen features island, quartz countertops in "Frost White", "Desert Grey" subway tile backsplash in brick pattern, Seattle Snow shaker cabinets, pantry cabinets, breakfast area with views to the backyard, and sink overlooking great room; Stainless steel microwave, dishwasher, and smooth top range!

...Read More Online

About The Community.

The town of Clayton, NC is one of the fastest-growing communities in the Triangle, but you'd never guess it from the quaint, small-town charm that abounds. From its quaint Downtown scene—complete with local shops and restaurants, a weekend farmers market, a library, and a performing arts center—to its beautiful local parks, trails, and golf courses, Clayton has something for everyone.

At Winston Pointe, you're just minutes from all the local favorites of Clayton! Tastings at Wine on Main, karaoke nights at Flipside Cafe, canine socials at the Dog Park, scenic walks along the Clayton River Walk... they're all just minutes outside your front door.

...Read More Online

Prices, plans, dimensions, features, specifications, materials, and availability of homes or communities are subject to change without notice or obligation. Illustrations are artists depictions only and may differ from completed improvements. All prices subject to change without notice. Please contact your sales associate before writing an offer.



ARCHIVED 11/08/2023

The Beaufort

CC3224

FIRST FLOOR

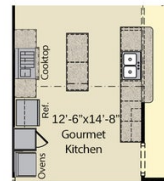

Gourmet Kitchen Option

SECOND FLOOR

