



232 Clear View School Road
Jacksonville, NC 28540

HAYDEN PLACE - PAMLICO

CONTACT OUR NEW HOME SPECIALISTS

MAGGIE & JESSICA

Call Us @ 910-405-8311

info@cavinessandcates.com



Priced

\$389,900

2,522 Sq Ft

2.0 Story

5 Beds

3.0 Baths

2 Car Garage

Primary Bedroom: Up

About 232 Clear View School Road

- Formal dining room off of foyer painted in Sherwin Williams "Software" with coffered ceiling and wainscoting detail
- Open kitchen with island overlooking the great room, granite countertops in "Luna Pearl", natural stone mosaic herringbone tile backsplash, white shaker cabinets, corner pantry, and breakfast area; Stainless steel microwave, dishwasher, and smooth top range.
- Great room with electric corner fireplace with decorative mantle and granite surround in "Absolute Black" and rear porch access through sliding glass door.

...Read More Online

About The Community.

COMING EARLY 2026

Why join the priority information list?

- ✓ Be the first to know - Get updates before the public on pricing, floorplans, and availability.
- ✓ Early access to pre-sales - Reserve your homesite and home plan before it's released to everyone else.

Designed with families in mind, Hayden Place offers the perfect blend of convenience, community, and natural beauty. Enjoy peaceful nature views while being just a short walk to Clearview Elementary, making school drop-offs a breeze. Plus, with Camp Lejeune just 11.5 miles away, MCAS New River's Main

...Read More Online

Prices, plans, dimensions, features, specifications, materials, and availability of homes or communities are subject to change without notice or obligation. Illustrations are artists depictions only and may differ from completed improvements. All prices subject to change without notice. Please contact your sales associate before writing an offer.



ARCHIVED 11/5/2024

THE PAMLICO CC2522

FIRST FLOOR

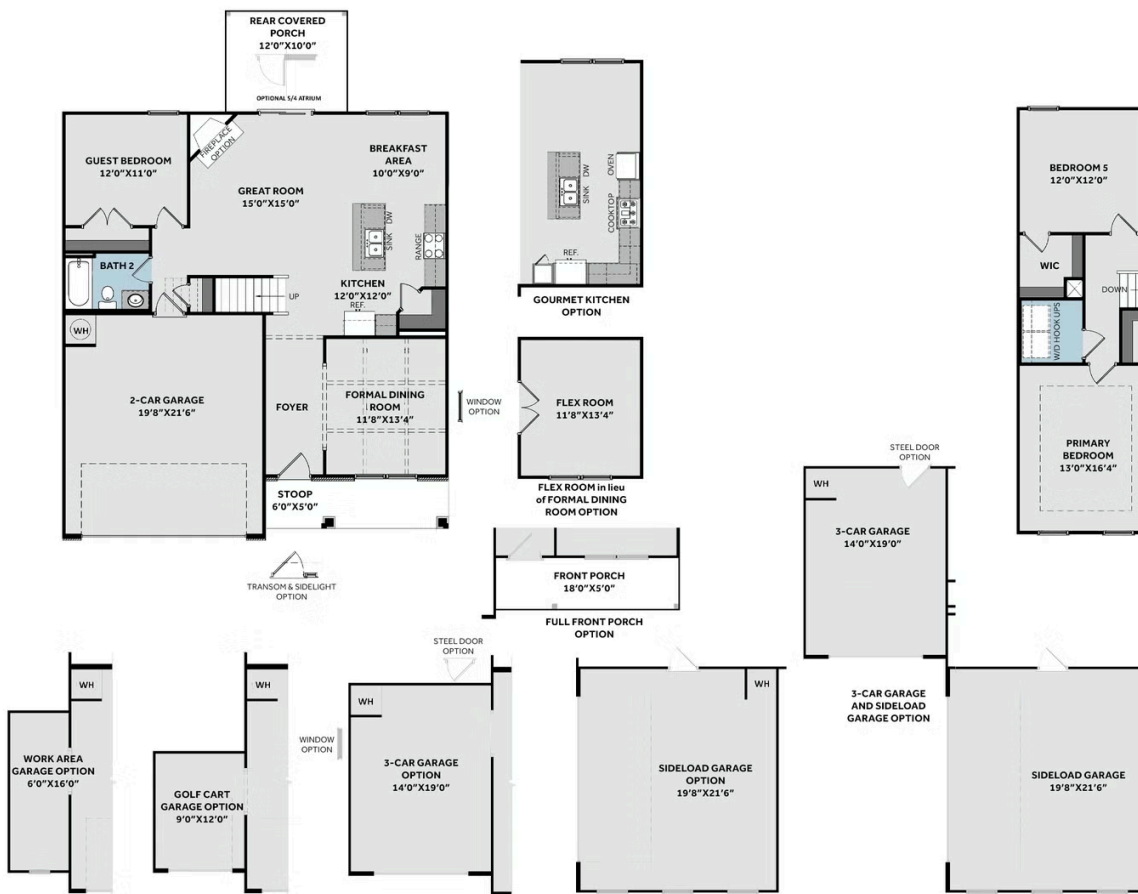

SECOND FLOOR

