



529 Ingram Ridge Court  
Knightdale, NC 27545

**GLENMERE GARDENS - PAGE**

CONTACT OUR NEW HOME SPECIALISTS

**MAGGIE & JESSICA**

Call Us @ 910-405-8311

info@cavinessandcates.com



**Priced**

**\$499,900**

Elevation KS

2,927 Sq Ft

2.0 Story

4 Beds

3.5 Baths

2 Car Garage

Primary Bedroom: Down

## About 529 Ingram Ridge Court

- First-floor master suite with tray ceiling, walk-in closet with sweater tower and wood shelving, double vanities with cultured marble countertops and framed mirrors, white shaker cabinets, linen closet, private water closet, garden tub with tile surround, and separate tiled shower.
- Great room with gas fireplace with built-ins on both sides, a decorative mantle and granite surround in "Steel Grey".
- Covered porch and grill patio is easily accessible through the great room.
- Kitchen open to great room with island, white shaker cabinets, granite countertops in "Luna Pearl",

...Read More Online

## About The Community.

**Award-winning Glenmere is the quintessential combination of location and style with impressive amenities such as a walk-in Jr. Olympic-sized pool, cabana with fireplace, open play area, tot lot, and future walking trails tying in with Wake County Greenway System.**

Glenmere brings that small-town charm together with everyday conveniences including shopping and a variety of restaurants in fast-growing Knightdale. The community is ideally situated with quick access to major highways, world-class healthcare, top-rated universities, and a quick ride to downtown Raleigh!

...Read More Online

Prices, plans, dimensions, features, specifications, materials, and availability of homes or communities are subject to change without notice or obligation. Illustrations are artists depictions only and may differ from completed improvements. All prices subject to change without notice. Please contact your sales associate before writing an offer.



ARCHIVED 1-7-2022

## The Page

CC2927

### FIRST FLOOR

### SECOND FLOOR

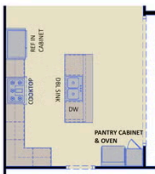

GOURMET KITCHEN

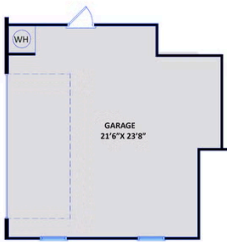
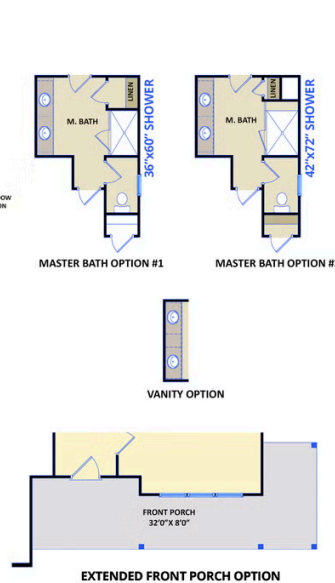

SIDE-LOAD GARAGE



3RD CAR GARAGE



WORK AREA @ GARAGE

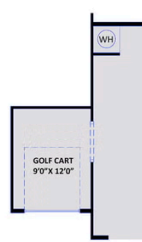

GOLF CART GARAGE

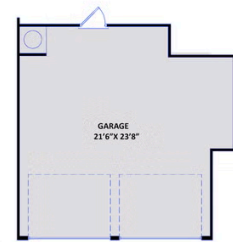

TWO-DOOR GARAGE



DOUBLE SINK OPTION



BEDROOM #4 BATH OPTION