



2813 Longleaf Pine Circle
 Leland, NC 28451
GRAYSON PARK - CLAYTON

CONTACT OUR NEW HOME SPECIALISTS
MAGGIE & JESSICA
 Call Us @ 910-405-8311
 info@cavinessandcates.com



Priced

\$449,900

- 2,560 Sq Ft
- 2.0 Story
- 4 Beds
- 3.5 Baths
- 2 Car Garage
- Primary Bedroom: Down

About 2813 Longleaf Pine Circle

*\$10,000 rate buydown or price reduction available!

- Great room with gas log fireplace with decorative mantle and granite surround in "Absolute Black"; Easy access to rear covered porch through great room.
- Formal dining room painted in Sherwin Williams "Rare Grey" with two-piece crown molding and board and batten wainscoting detail.

...Read More Online

About The Community.

Grayson Park is a beautiful community in Leland, North Carolina within Brunswick County. Only 12 minutes to downtown Wilmington and surrounded by all the city and coast have to offer! Grayson Park offers an attractive natural setting with abundant wooded areas and ponds. Amenities include a clubhouse with a catering kitchen; a competition-size swimming pool and kiddie pool; lighted tennis courts; playground; sidewalks; and walking trails! Visit Grayson Park today and find a place to call home!

...Read More Online

Prices, plans, dimensions, features, specifications, materials, and availability of homes or communities are subject to change without notice or obligation. Illustrations are artists depictions only and may differ from completed improvements. All prices subject to change without notice. Please contact your sales associate before writing an offer.



The Clayton
CC2560

FIRST FLOOR



SECOND FLOOR

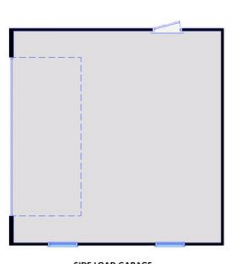
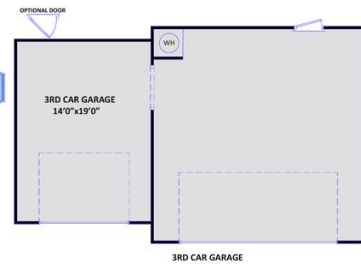
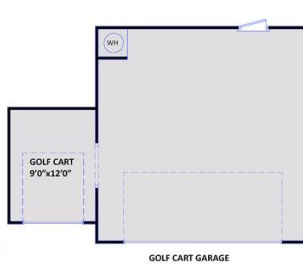
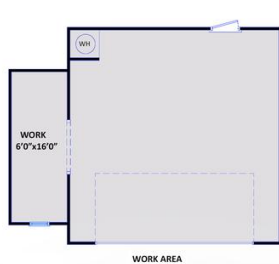

Prices, plans, dimensions, features, specifications, materials, and availability of homes or communities are subject to change without notice or obligation. Illustrations are artists depictions only and may differ from completed improvements. All prices subject to change without notice. Please contact your sales associate before writing an offer.

