



268 Tulip Oak Drive  
Raeford, NC 28376  
**BROOKSTONE VILLAGE - PAMLICO**

CONTACT OUR NEW HOME SPECIALISTS

**MAGGIE & JESSICA**

Call Us @ 910-405-8311

info@cavinessandcates.com



**Priced**

**\$379,800**

2,522 Sq Ft

2.0 Story

5 Beds

3.0 Baths

2 Car Garage

Primary Bedroom: Up

## About 268 Tulip Oak Drive

- First-floor flex room with full lite french doors, wainscotting detail, and crown molding.
- Open kitchen with island overlooking the great room, granite countertops in "New Caledonia", white shaker cabinets, subway tile backsplash in "Arctic White" set in a brick pattern, corner pantry, and breakfast area; Stainless steel microwave, dishwasher, and smooth top range.
- Great room features a corner gas fireplace with a decorative mantle and granite surround in "Absolute Black" and access to rear porch and grill patio through sliding glass door.
- Guest room located on first floor with hall access to full bathroom with vanity, white shaker

...Read More Online

## About The Community.

Find your place to call home in **Brookstone Village**, a gated community that combines everyday convenience with a welcoming neighborhood feel. Ideally located just off HWY 401 in Raeford, you're minutes from everything—whether it's work, errands, or fun.

Right outside your door, enjoy **on-site amenities** designed for relaxation and connection, including walking trails, a dog park, and a community grilling area perfect for cookouts with friends and neighbors. Just around the corner, you'll find **First Health Moore Regional Hospital and First Health Convenient**



...Read More Online

Prices, plans, dimensions, features, specifications, materials, and availability of homes or communities are subject to change without notice or obligation. Illustrations are artists depictions only and may differ from completed improvements. All prices subject to change without notice. Please contact your sales associate before writing an offer.



ARCHIVED 11/5/2024

## THE PAMLICO CC2522

### FIRST FLOOR

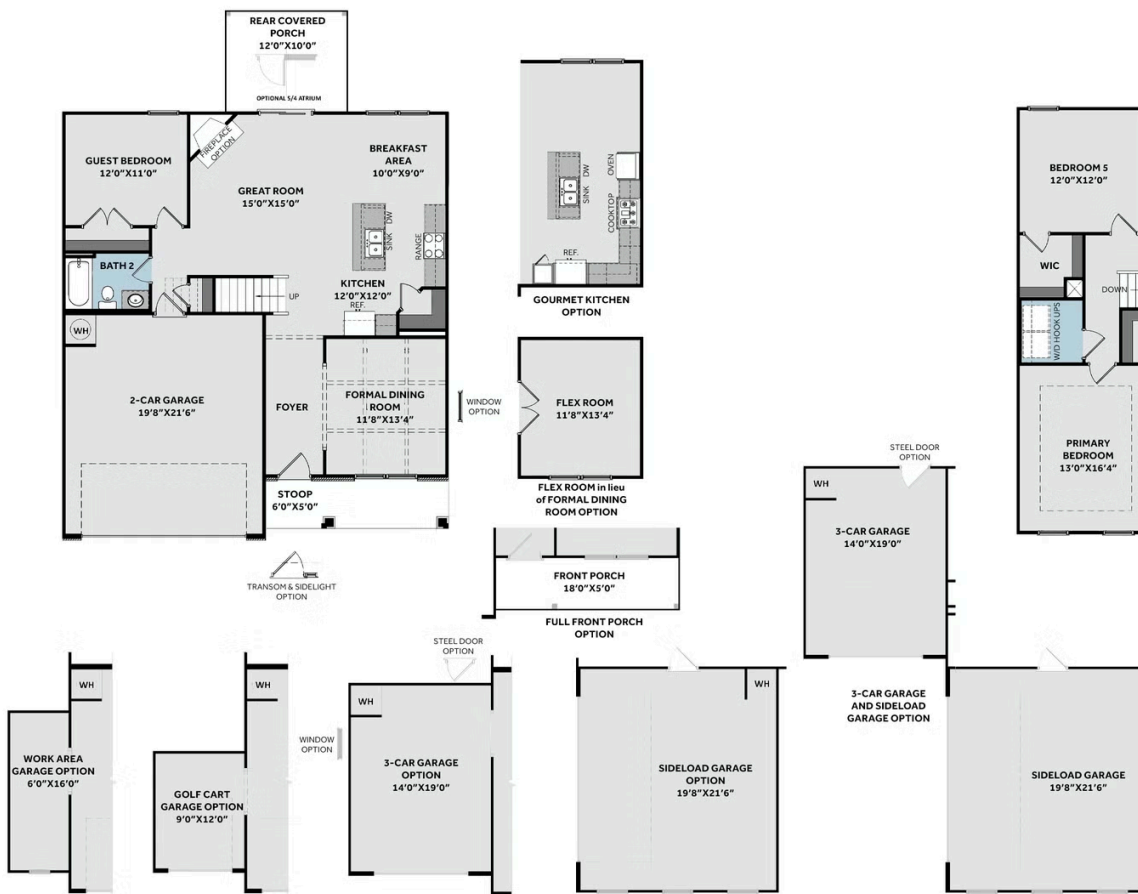

### SECOND FLOOR

