



144 Centerline Drive
Selma, NC 27576

EASTOVER - RIVERMIST

CONTACT OUR NEW HOME SPECIALISTS

MAGGIE & JESSICA

Call Us @ 910-405-8311

info@cavinessandcates.com



Priced

\$382,900

Elevation K - ARCHIVED 3/8/2022

2,695 Sq Ft

2.0 Story

4 Beds

3.5 Baths

3 Car Garage

Primary Bedroom: Down

About 144 Centerline Drive

- The Rivermist home features a stunning 2 story great room with second-floor catwalk, and a gas log fireplace
- Covered porch creates the perfect outdoor living space
- Kitchen features granite countertops, subway tile backsplash, white cabinets, stainless steel microwave, dishwasher, and smooth cooktop range, satin nickel finishes, sink overlooking the great room, island, and pantry cabinet
- Elegant formal dining room with stunning coffered ceiling and wainscoting detail

...Read More Online

About The Community.

Eastover is a cozy community of just 20 homes. Enjoy the quiet, country living complete with community pond access with the convenience of local shopping, dining, and activities. Do your grocery shopping or curbside pickup less than 10 minutes away at your local Harris Teeter. Frequent local shopping and restaurants are less than a 20-minute drive to charming downtowns Clayton, Selma, Wendell, and Smithfield. Your commute is easy with quick access to highway 70 and I-95. Find your place to call home in Eastover!

...Read More Online

Prices, plans, dimensions, features, specifications, materials, and availability of homes or communities are subject to change without notice or obligation. Illustrations are artists depictions only and may differ from completed improvements. All prices subject to change without notice. Please contact your sales associate before writing an offer.



ARCHIVED

The Rivermist
CC2695

FIRST FLOOR



SECOND FLOOR

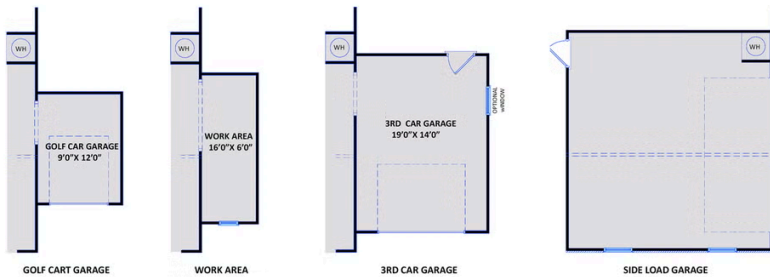

DOUBLE BOWL OPTION

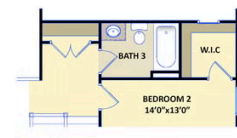

3RD FULL BATH OPTION