



230 Elijah Way  
Vass, NC 28394

**LONG POINT RESERVE - LOOKOUT**

CONTACT OUR NEW HOME SPECIALISTS

**MAGGIE & JESSICA**

Call Us @ 910-405-8311

info@cavinessandcates.com



**Priced**  
**\$317,900**

Similar Home-Artistic Rendering for  
Representation Purpose Only

1,658 Sq Ft

2.0 Story

3 Beds

2.5 Baths

1 Car Garage

Primary Bedroom: Up

## About 230 Elijah Way

- Step into this thoughtfully designed end-unit townhome through a welcoming foyer featuring a coat closet and a convenient powder room.
- The kitchen overlooks the dining area and great room and includes a large island with seating, white shaker cabinets, "Giallo Ornamental" granite countertops, tile backsplash, a pantry, and stainless steel appliances—including a smooth top range, microwave, and dishwasher.
- From the dining area, step onto the covered rear porch with an exterior storage closet.
- Durable LVP flooring enhances the first floor.

...Read More Online

## About The Community.

Welcome to Long Point Reserve, located just off US-1, this community offers a quiet countryside setting with convenient access to everything you need. Featuring a mix of townhomes and single-family homes starting from the \$300s, this neighborhood is thoughtfully planned into the backdrop of the serene town.



Rural Setting with Community Comforts Surrounded by the natural beauty of Moore County, this community offers a relaxed lifestyle with amenities, including:

Swimming Pool & Pool House – Ideal for summer relaxation and neighborhood gatherings

Walking Trail - Take a walk and enjoy the surrounding pines

Proposed Dog Park – A future space for your four-legged family members to play and socialize

...Read More Online

Prices, plans, dimensions, features, specifications, materials, and availability of homes or communities are subject to change without notice or obligation. Illustrations are artists depictions only and may differ from completed improvements. All prices subject to change without notice. Please contact your sales associate before writing an offer.



## THE LOOKOUT

TH1658 - RIGHT END UNIT

### FIRST FLOOR

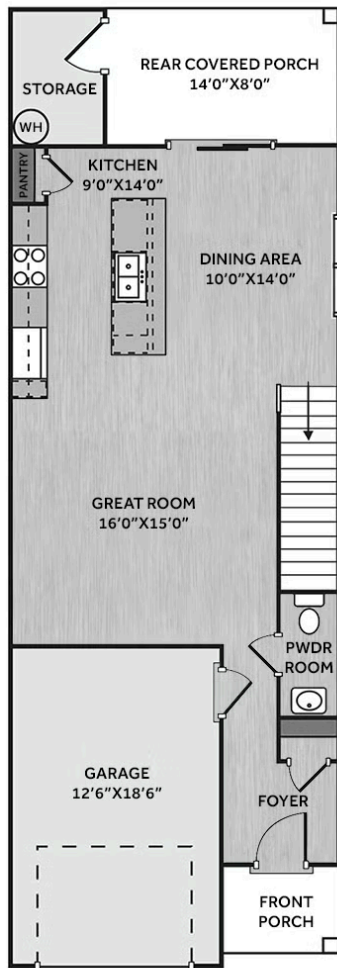

### SECOND FLOOR

