



432 E. Clydes Point Way  
Wendell, NC 27591

**MAGGIE WAY - GRAHAM**

CONTACT OUR NEW HOME SPECIALISTS

**MAGGIE & JESSICA**

Call Us @ 910-405-8311

info@cavinessandcates.com



**Priced**

**\$449,900**

2,048 Sq Ft

2.0 Story

3 Beds

2.5 Baths

3 Car Garage

Primary Bedroom: Up

## About 432 E. Clydes Point Way

**\$10,000 + Blinds & Fridge Builder Incentive! Apply toward closing costs or rate buydown on contracts dated on or before 12/31/25. Conditions apply. Click here for details.**

- Nearly 1 acre lot! (.92 acres)
- Off the foyer, a versatile flex room with French door entry offers the perfect space for a home office or study, while a conveniently located half-bath adds extra functionality.
- The open-concept main living area seamlessly connects the kitchen, dining area, and great room, fostering a natural flow for entertaining and everyday living.

...Read More Online

## About The Community.

Classic and understated style, coupled with an ideal location and approachable affordability lead you home to Maggie Way! Cool off by the pool or cast a line into the five-acre lake. Your community offers a spacious "Tot Lot" where kids of all ages will have room to roam and scale the brand-new playground. Located in the peaceful rural community of Archer Lodge, Maggie Way might feel like a serene country escape, but it's only a few short minutes from the big city opportunities of Raleigh. For those who want the best of both worlds, who want big city life without being overwhelmed by it, who still love the scent of clean air and the sight of unsullied blue skies, and who want to work, play, and live their best lives in their



...Read More Online

Prices, plans, dimensions, features, specifications, materials, and availability of homes or communities are subject to change without notice or obligation. Illustrations are artists depictions only and may differ from completed improvements. All prices subject to change without notice. Please contact your sales associate before writing an offer.



## FIRST FLOOR

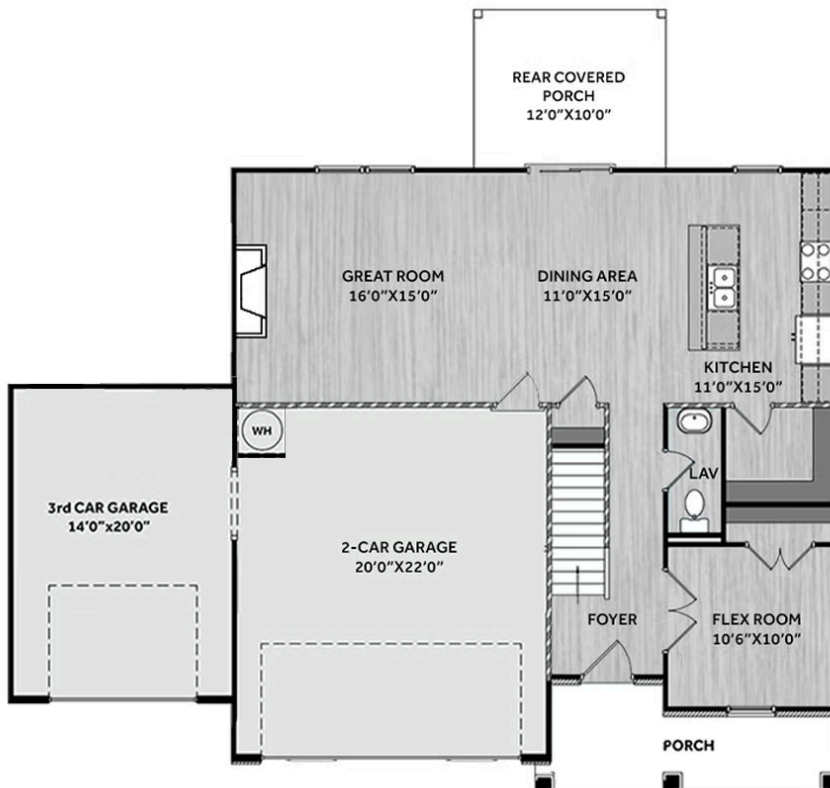

## SECOND FLOOR

