



74 Cardovia Way
Wendell, NC 27591

MAGGIE WAY - BRUNSWICK

CONTACT OUR NEW HOME SPECIALISTS

MAGGIE & JESSICA

Call Us @ 910-405-8311

info@cavinessandcates.com



Priced

\$489,900

2,355 Sq Ft

2.0 Story

4 Beds

2.5 Baths

2 Car Garage

Primary Bedroom: Up

About 74 Cardovia Way

***Limited Time Offer! Get \$10,000 as a "Use As You Choose" builder incentive to be used toward closing costs, rate buydown, and/or design studio upgrades! Conditions apply.**

- This beautifully crafted home offers a spacious great room with a gas log fireplace and floating mantel, plus easy access to the rear covered porch from the breakfast area—ideal for relaxing outdoors.
- The kitchen features a large island, "Trigato" quartz countertops, white shaker cabinets with a "Sahara" accent island, horizontal ceramic tile backsplash, walk-in pantry, built-in desk, and

...Read More Online

About The Community.

Classic and understated style, coupled with an ideal location and approachable affordability lead you home to Maggie Way! Cool off by the pool or cast a line into the five-acre lake. Your community offers a spacious "Tot Lot" where kids of all ages will have room to roam and scale the brand-new playground. Located in the peaceful rural community of Archer Lodge, Maggie Way might feel like a serene country escape, but it's only a few short minutes from the big city opportunities of Raleigh. For those who want the best of both worlds, who want big city life without being overwhelmed by it, who still love the scent of clean air and the sight of unsullied blue skies, and who want to work, play, and live their best lives in their

...Read More Online

Prices, plans, dimensions, features, specifications, materials, and availability of homes or communities are subject to change without notice or obligation. Illustrations are artists depictions only and may differ from completed improvements. All prices subject to change without notice. Please contact your sales associate before writing an offer.



FIRST FLOOR

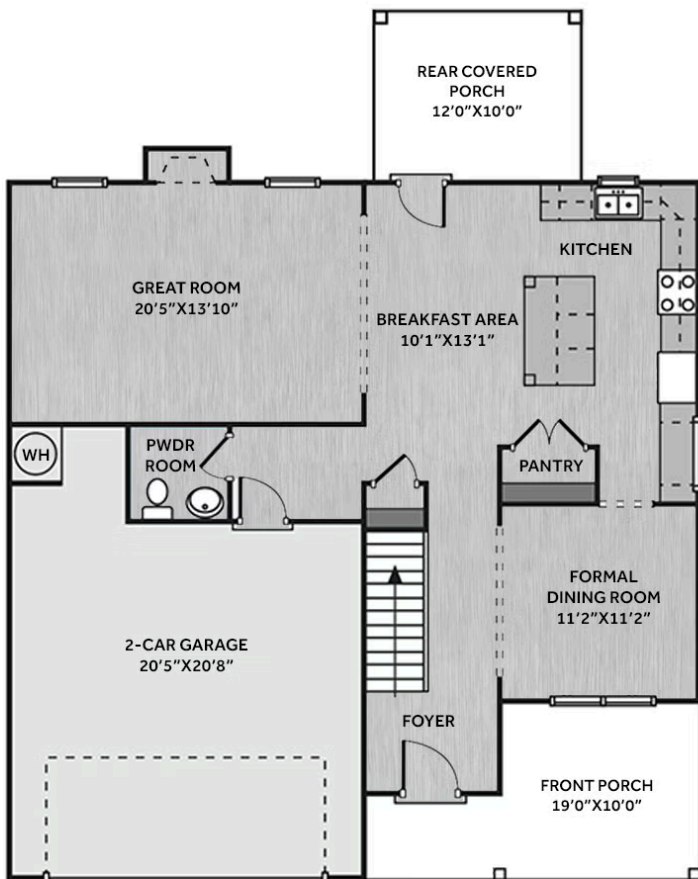

SECOND FLOOR

